

Fans

RKWA

The RKWA flying lines has been designed to get high performances with a compact look, and with the widest application availability typical of variable pitch angle fans.

The blades stiffness and the asymmetric configuration assure reliability and silence in the heavy duty applications on earth-moving and agri machines.

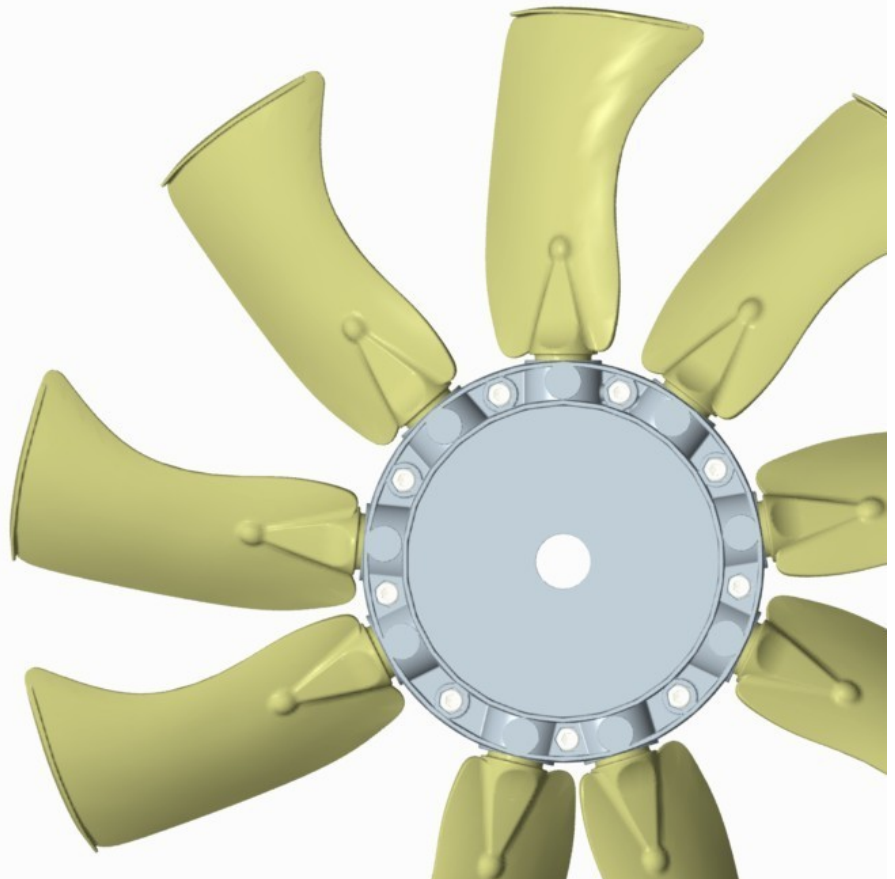

TECHNICAL FEATURES

- 9 blades in PA66 GF30
- Diecasted aluminium hubs
- Customized diameter on request, max 482mm
- Puller clockwise rotation
- Variable pitch 30° to 45°
- Temperature range -30°C to +110°C
- Customized fixing holes
- Possibility of assembling standard diecasted alu hubs



Via Torino 272, 10040 Leini (TO) Italy

Tel.: (+39) 011.998.07.77

Fax: (+39) 011.997.35.35

<http://www.fratellirosati.it>

E-mail: info@fratellirosati.it

Fans

RKWA

Clockwise rotation

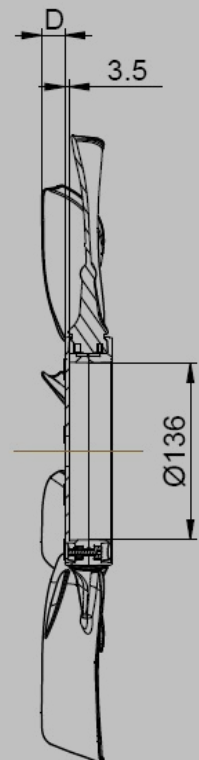
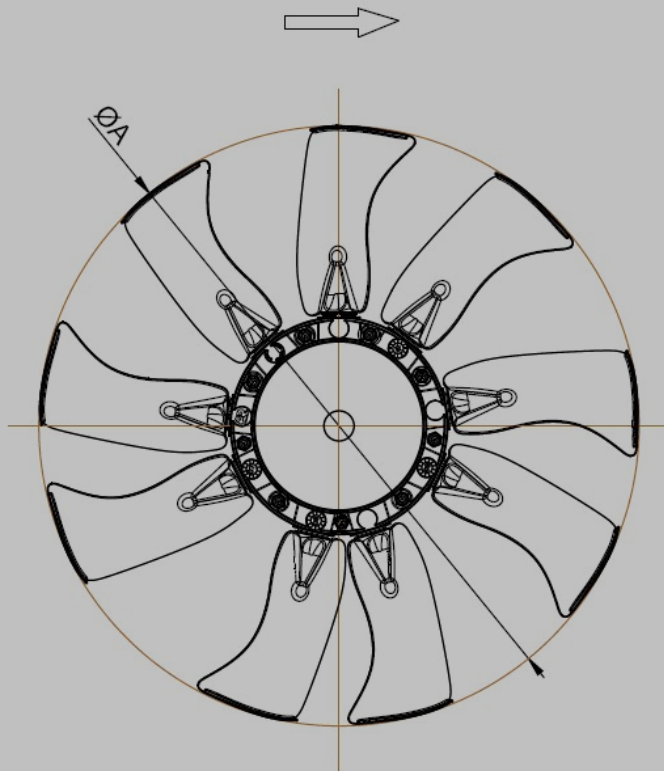

$\varnothing A$	B	C	D
482	55	45	19
	57	51	21
	59	57	23
	61	65	25

All measures are expressed in millimeters.