

Fan

J11

J11 fan is designed to reach high performances and low power consumption with a very compact design.

The J11 fan solution is able to satisfy the needs of cooling system in earth-moving machines, tractors and industrial vehicles.

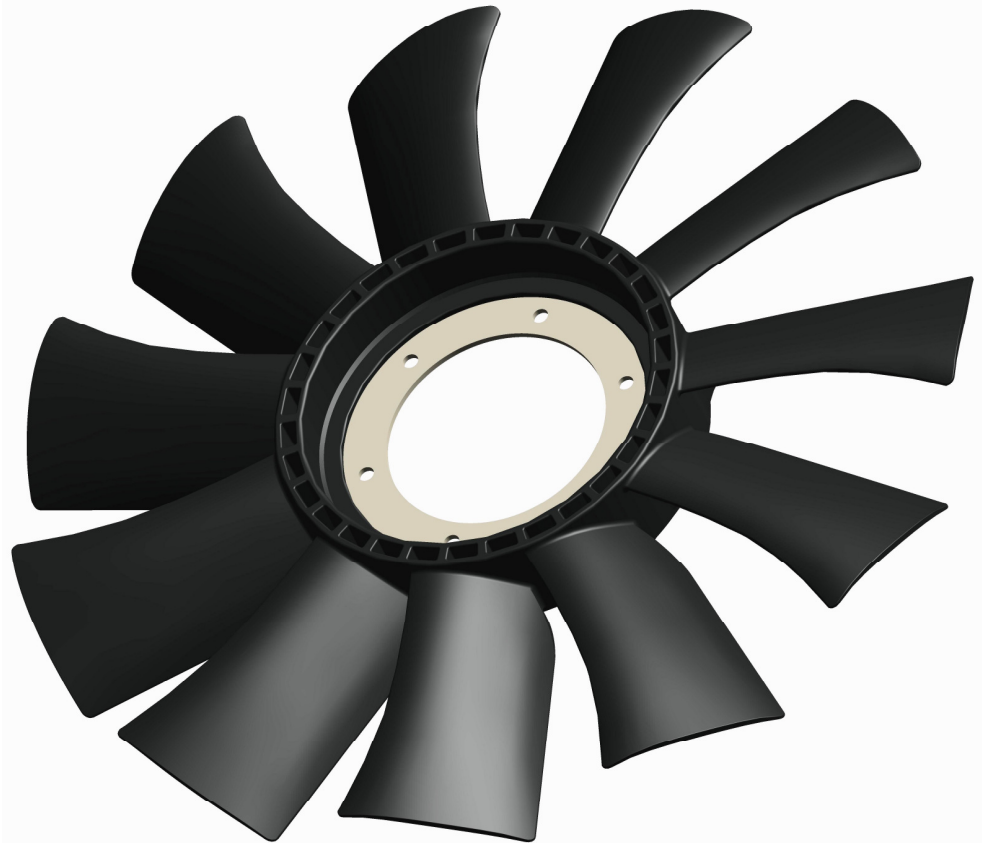

TECHNICAL FEATURES

- Injected one-piece fan in PA6 GF30
- Clockwise puller rotation
- 11 blades
- 2 standard diameters : 620 and 550 mm
- 2 standard central holes : 127.0 and 82.6 mm
- 3.5 mm galvanized central metal plate
- Temperature range -30°C to +110°C
- Suitable for bimetal and electronic visco driving
- Fan diameter customized on request
- Central fixing holes customized on request



Via Torino 272, Leinì (To) - Italia

www.fratellirosati.it